

- NOTES:**
- FOR CORRESPONDING SCHEME DRAWINGS, REFER TO APPENDIX 0/4.
 - FOR DETAILS OF STATUTORY UNDERTAKE APPARATUS PROCEDURES/PRECAUTIONS RELATING TO THE CONSTRUCTION OF THIS SCHEME, REFER TO APPENDIX 1/16.
 - FOR APPROXIMATE LOCATION OF STATUTORY UNDERTAKERS APPARATUS WITHIN THE SITE EXTENT, REFER TO SECTION 4 OF THE SPECIFICATION FOR WORKS VOLUME 2.
 - FOR DETAILS OF TEMPORARY TRAFFIC MANAGEMENT REQUIREMENTS, REFER TO APPENDIX 1/17.
 - FOR DETAILS OF ADVANCED SIGNS, REFER TO APPENDIX 1/21. EXACT LOCATION OF THESE SIGNS ARE TO BE AGREED ON SITE WITH THE OVERSEEING ORGANISATION.

KEY

----- SCHEME EXTENTS

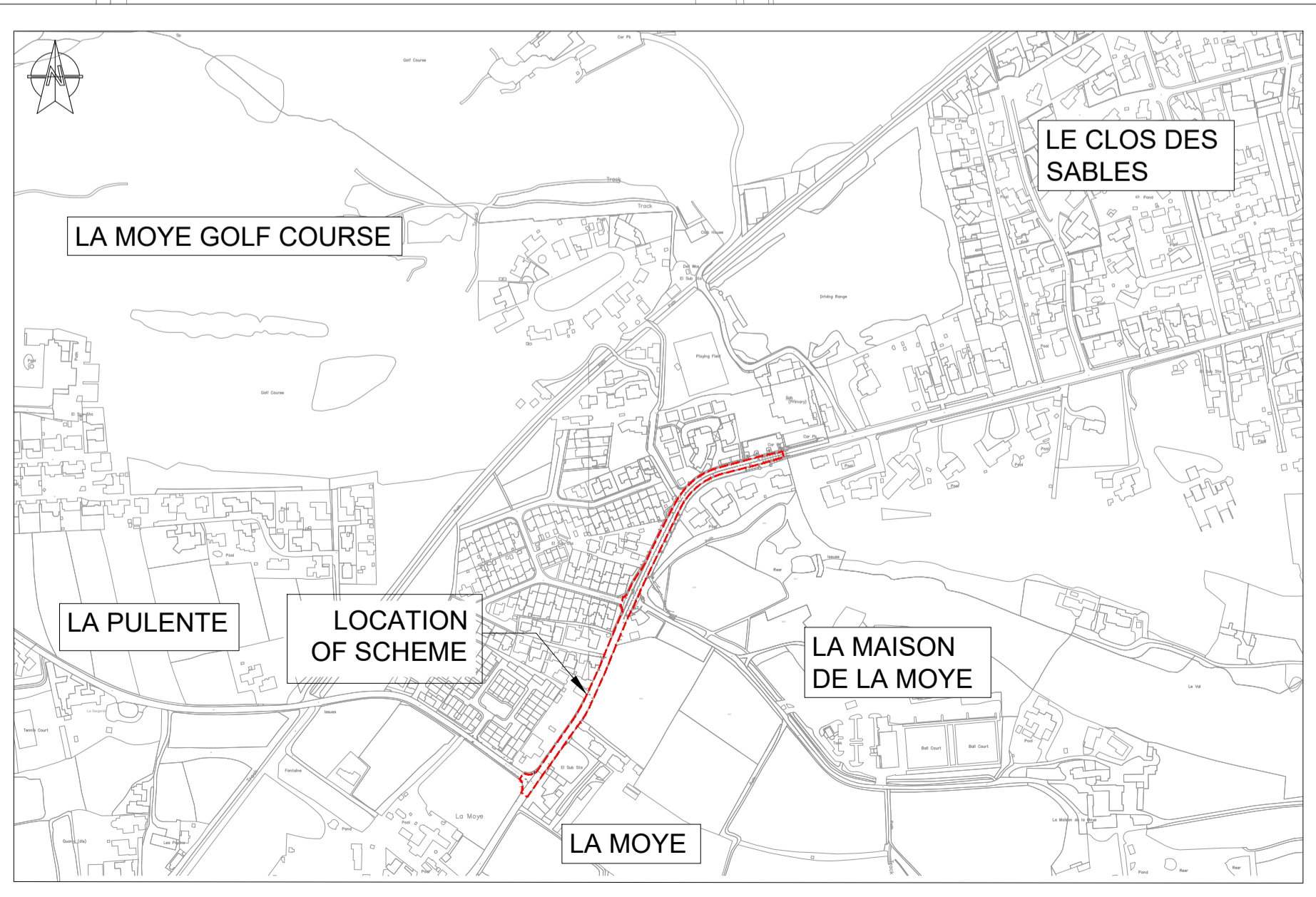
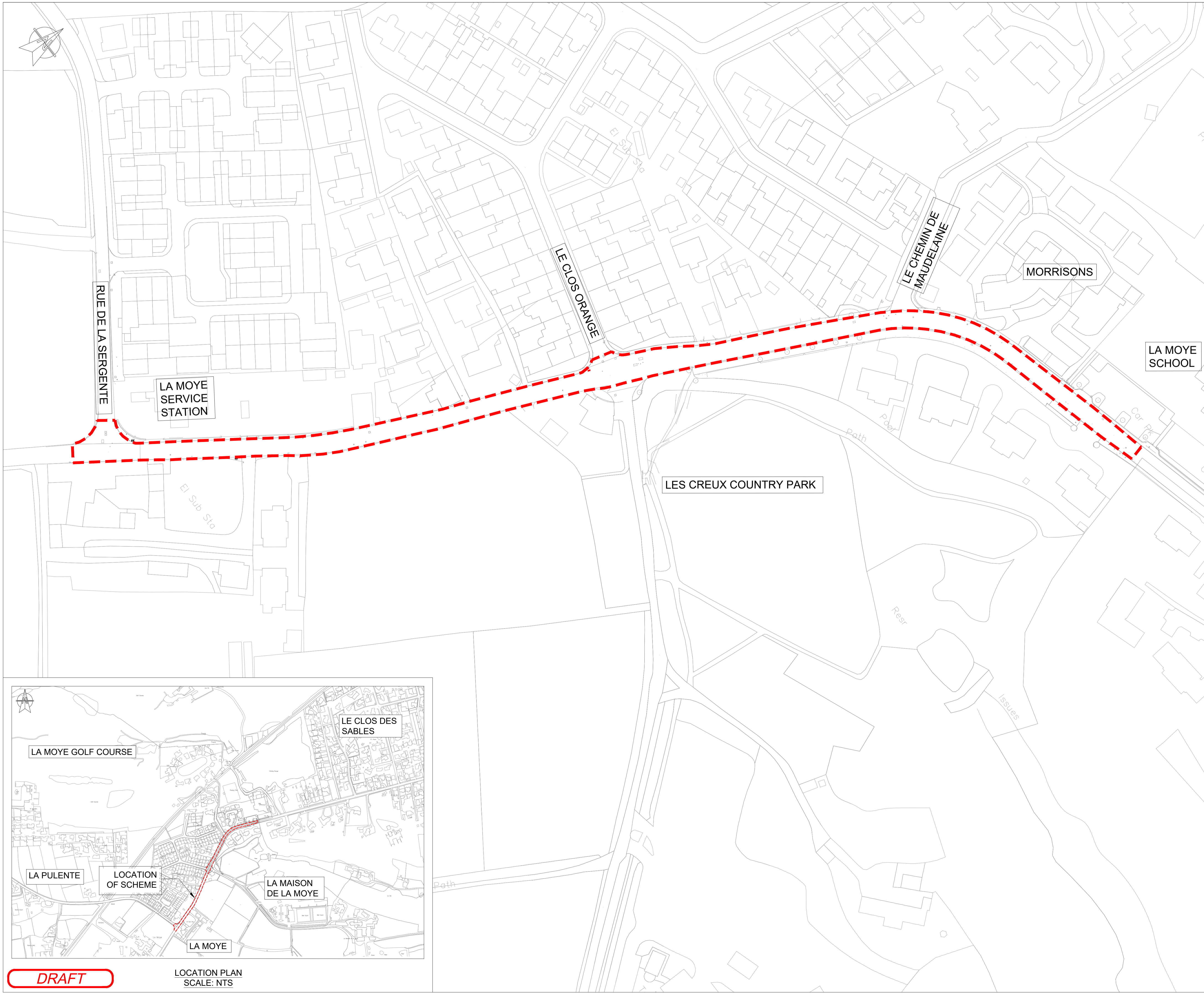

DRAFT LOCATION PLAN SCALE: NTS

Rev.	Date	Details
-	29/04/2021	FIRST ISSUE

Infrastructure, Housing and Environment

Government of JERSEY

Highways and Infrastructure Section

P.O. Box 412, Beresford House,
Bellozanne Road, St Helier,
Jersey JE4 8UY

Tel: +44 (0)1534 445509 website: www.gov.je
Fax: +44 (0)1534 445529

Project

**ROUTE ORANGE
RESURFACING SCHEME**

Title

**SCHEME EXTENTS AND
LOCATION PLAN**

Drawn by: KKR	Checked by: DG
Scale: NTS	Date: 18/05/2021